



Power relay, AC-3 8.4 A, 4 kW / 400 V 3 NO+1 NC, 24 V AC, 45...450 Hz 3 pole, flat connector terminal 6.3 x 0.8mm

<b>reference code acc. to IEC 81346-2</b>	K
Substance Prohibitance (Date)	01.07.2006 00:00:00
ambient temperature during operation	-25 ... +55 °C
<b>number of poles</b>	4
<b>number of NO contacts for main contacts</b>	3
<b>number of NC contacts for main contacts</b>	0
<b>type of voltage</b>	AC
<b>operational current</b>	
• at AC-1 at 400 V rated value	16 A
• at AC-3 at 400 V rated value	8.4 A
<b>operating power</b>	
• at AC-3 at 400 V rated value	4 kW
<b>control supply voltage at AC</b>	
• at 50 Hz rated value	24 ... 24 V
• at 60 Hz rated value	24 ... 24 V
<b>supply voltage frequency for auxiliary and control circuit rated value</b>	45 ... 450 Hz
<b>number of NC contacts for auxiliary contacts</b>	1
<b>number of NO contacts for auxiliary contacts</b>	0
number of CO contacts for auxiliary contacts	0
<b>fastening method</b>	screw and snap-on mounting onto 35 mm standard mounting rail
• side-by-side mounting	Yes
<b>height</b>	62 mm
<b>width</b>	36 mm
<b>depth</b>	61 mm
<b>type of electrical connection</b>	
• for main current circuit	tab terminals
• for auxiliary and control circuit	tab terminals

### Safety related data

<b>protection class IP on the front acc. to IEC 60529</b>	IP00
---	------

### Further information

Information- and Downloadcenter (Catalogs, Brochures,...)

<https://www.siemens.com/ic10>

Industry Mall (Online ordering system)

<https://mall.industry.siemens.com/mall/en/en/Catalog/product?mlfb=3TG1001-1AC2>

Cax online generator

<http://support.automation.siemens.com/WWW/CAXorder/default.aspx?lang=en&mlfb=3TG1001-1AC2>

Service&Support (Manuals, Certificates, Characteristics, FAQs,...)

<https://support.industry.siemens.com/cs/ww/en/ps/3TG1001-1AC2>

Image database (product images, 2D dimension drawings, 3D models, device circuit diagrams, EPLAN macros, ...)

[http://www.automation.siemens.com/bilddb/cax\\_de.aspx?mlfb=3TG1001-1AC2&lang=en](http://www.automation.siemens.com/bilddb/cax_de.aspx?mlfb=3TG1001-1AC2&lang=en)

Characteristic: Tripping characteristics,  $I^2t$ , Let-through current

<https://support.industry.siemens.com/cs/ww/en/ps/3TG1001-1AC2/char>

Further characteristics (e.g. electrical endurance, switching frequency)

<http://www.automation.siemens.com/bilddb/index.aspx?view=Search&mlfb=3TG1001-1AC2&objecttype=14&gridview=view1>

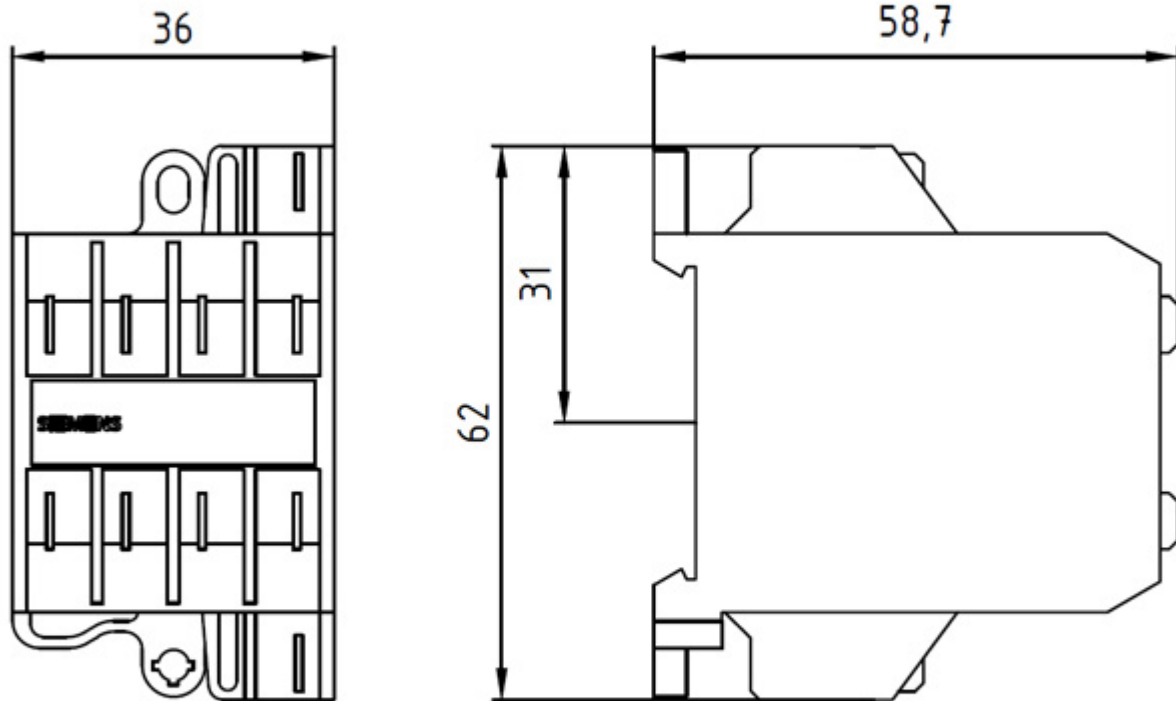

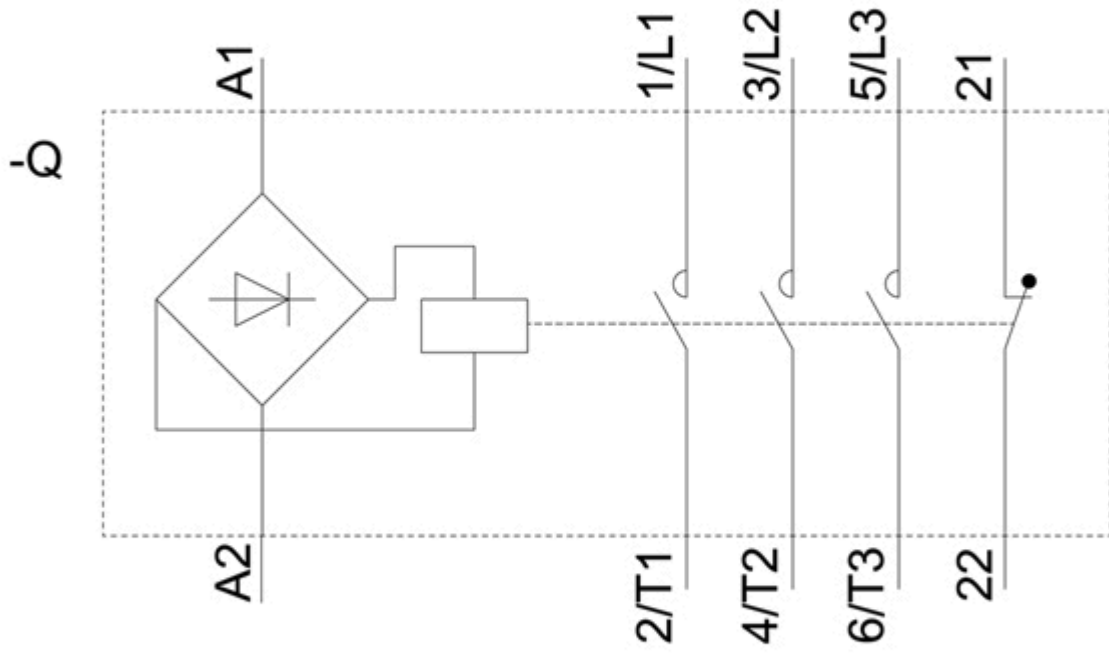

last modified:

1/18/2021 